



α PRI40

Features

- 40 mm case diameter
- 100- 200- 360-500-600- 1000-1024 ppr.
- Push-Pull, TTL Linedriver and HTL Linedriver outputs
- Shaft diameter 4 - 6 mm
- 3500 rpm max.



Technical Specifications

Resolution	1 00 to 1 024 ppr.
Output Channels	A,B,Z or A,Ā, B,Ī, Z,Ż
Output type	Push-Pull, TTL Linedriver, HTL Linedriver
Supply voltage	5V DC or 8-24V DC or 5-24V DC
Power Consumption	(without load) < 40 nA (24 VDC)
Cable	2.5m (Standard) 5 Wire+ Shield for Pushpull 2.5m (Standard) 8 Wire + Shield for Linedriver
Max. Permissible Shaft Loading Radial	80N

Max. Speed	3.500 rpm
Shaft Diameter	Ø4-6mm
Shaft Material	Stainless Steel
Case Diameter	Ø40mm
Case Material	Aluminium and Painted Steel
IP degree	IP 54
Operating temperature	-20°C ... +80°C
Storage temperature	-30°C ... +90°C

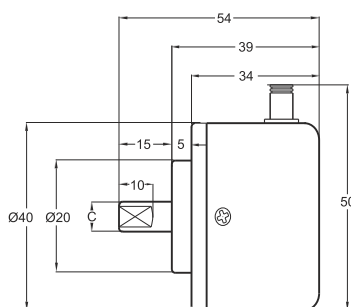

Shaft type / Radial

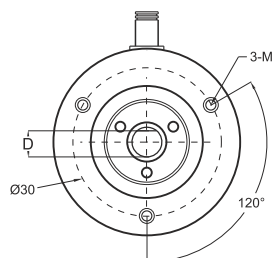

PRI 40	R (shaft)	
	C	D
	Ø4mm	3.30mm
	Ø6mm	5.30mm

Push-Pull Cable Output

- +V : Brown
- 0V : White
- GND : Shield
- Ch A : Yellow
- Ch B : Green
- Ch Z : Gray

TTL - HTL Linedriver Cable Output

- +V : Brown
- 0V : White
- GND : Shield
- Ch A : Yellow
- Ch B : Green
- Ch Z : Gray
- Ch A inv.: Blue
- Ch B inv.: Red
- Ch Z inv.: Pink

Model	Case Diameter	Case Type	Shaft Diameter	Output Type	Resolution	Output Channels	Supply Voltage	Connector / Cable	Cable Output
(example) PRI	40	A	R6	HLD	1024	Z	V2	2M5	R
PRI	40mm	A : Clamping flange	R4 : 4mm R6 : 6mm	LTP : Push-Pull LD : TTL Linedriver HLD : HTL Linedriver	100 ... 1024 ppr.	Z : A, B, Z B : Ā, B̄ ZZ : Ā, B̄, Ż	V1 : 5V DC V2 : 8-24V DC V3 : 5-24V DC	2M5 : 2,5 meter cable 5M : 5 meter cable	R : Radial

07.2019 | version 0001

The information provided herein is to the best of our knowledge true and accurate, it is provided for guidance only. All specifications are subject to change without prior notification.

Althen – Your expert partner in Sensors & Controls | althensensors.com

Althen stands for pioneering measurement and custom sensor solutions. In addition we offer services such as calibration, design & engineering, training and renting of measurement equipment.

Germany / Austria / Switzerland
info@althen.de

Benelux
sales@althen.nl

France
info@althensensors.fr

Sweden
info@althensensors.se

USA / Canada
info@althensensors.com

Other countries
info@althensensors.com